



Meetings That Hit Big

Turning Stone[®]
RESORT | CASINO

A Destination That Inspires

The natural beauty of Upstate New York's heartlands blends seamlessly with world-class amenities at Turning Stone Resort Casino, winner of the Forbes Travel Guide Four-Star Award and AAA Four Diamond Award.

- 225,000 sq. ft. of meeting space
- 1,046 guest rooms, from relaxed to lavish
- Flexible, contiguous rooms for general sessions and breakout sessions
- 20+ dining options, from fine dining to quick and convenient
- Two luxury spas for relaxation and rejuvenation
- Three award-winning golf courses
- 10+ nightlife options featuring live music, cocktails and more
- Centrally located — easy travel by air, car or rail





More Wow on the Way

In April 2027, a \$370 million evolution will make Turning Stone Upstate New York's largest event destination, while preserving the personalized service you deserve.

The Grand Expo

This majestic, state-of-the-art addition nearly doubles our convention and conference space. It features grand ballrooms, luxe breakout rooms, expansive, pillarless spaces, towering ceilings, natural light and spectacular courtyards.

The Crescent

Soon a magnificent new hotel will offer 258 thoughtfully appointed rooms and suites that leave no element of indulgence untended — with a magnificent, dedicated entrance and direct access to The Grand Expo and indoor parking.

Salt: Seafood & Raw Bar

Four dedicated rooms and an outdoor terrace offer private group dining for up to 40 guests. This trend-setting new restaurant offers a voguish ambiance, upscale cuisine and exclusive spaces designed to impress your guests.





Lodging That Elevates

The Lodge

Our gorgeous woodland retreat offers elegant luxury suites with separate workspaces.

The Crescent

In 2027, this stunning new hotel will elevate our guests to new heights of extravagance and comfort, featuring a signature indoor-outdoor seafood restaurant.

The Tower

Contemporary, stylish rooms and suites with panoramic views — topped with the award-winning TS Steakhouse on the penthouse floor.

The Brook

Located at the heart of the resort, The Brook offers rooms and suites with convenient access to meetings, dining and more.

Sandstone Hollow Inn

This relaxed, friendly inn is a short, complimentary shuttle ride from the main campus.

The Inn

Comfortable, relaxed rooms and staff who make you feel welcome. You can also enjoy a complimentary breakfast and complimentary shuttle ride to the casino.



Dining That Wows

Enjoy private group dining and indulge in culinary excellence at your choice of over 20 signature restaurants.

Wildflowers

Honored with the AAA Four Diamond Award and the Forbes Travel Guide Four-Star Award, Wildflowers sets the standard for atmosphere and culinary excellence with locally sourced, seasonal dishes.

TS Steakhouse

Located on the 21st floor of The Tower, TS Steakhouse features classic cuts, chops and cocktails with panoramic views, fine cigars and spirits.

Peach Blossom

Peach Blossom combines Chinese and Thai cuisine with variety, freshness, sweet and spicy flavors. Our chefs create artistic and succulent dishes that satisfy your palate and delight your eyes.

Pino Bianco

Nestled in the center of the resort, Pino Bianco is an Italian-style restaurant where dinner is served up in a casual yet sophisticated setting.

Salt: Seafood & Raw Bar

Coming in 2027, this trend-setting restaurant will offer four private dining areas and terrace seating.





7 Kitchens

A station-style buffet with a robust menu to appeal to every palate. Choose from Asian, Italian, Mediterranean, seafood, tacos, meats, the grill and desserts.

NY Rec & Social Club

Unleash your competitive spirit, savor signature cocktails and win over your hunger. Epic eats, ranging from shareable snacks to gourmet delights, hit the spot every time.

The Food Hall at Turning Stone

Stop in at the Food Hall for six unique dining options ranging from hot corned beef sandwiches to margherita pizza, General Tso's chicken, Philly burgers, fried chicken and shredded pork quesadillas.

Sushi Sushi

A variety of Sashimi, Nigiri and Maki rolls are handcrafted by our Sushi Chef — featuring his daily selection of the highest-quality fish and steaming Asian Noodles. Take a seat and enjoy the art of sushi making.

Emerald Restaurant

Emerald serves casual fare in a comfortable, relaxed setting. Choose from a classic American menu ranging from breakfast to fresh salads, sandwiches, burgers and dinners, available for dine-in and takeout 24 hours a day.

The Upstate Tavern

From local ingredients to local brews, the menu offers culinary creations that are time-honored, New York-inspired, and familiar American classics prepared from scratch.

Tin Rooster Honky Tonk

At Tin Rooster, the pig is sacred, the beer is cold and the atmosphere is country Americana at its finest. Our BBQ features signature flavors that may start a finger-lickin' obsession.

Opals Confectionery

Indulge in fresh hot coffee, a just-baked muffin or house-made fudge at Opals. A tempting array of rich confections will satisfy your sweet tooth.

The Grille at Shenendoah

Grab a bite in this stone-and-cedar-style clubhouse. The Grille at Shenendoah features a full breakfast menu. Open seasonally with outdoor al fresco dining.

Tower Lounge

Enjoy a vibrant atmosphere and a wonderful selection of cocktails and nosh-ready snacks.

The Lodge Lounge

The bar provides panoramic views of the western sky overlooking The Great Lawn. This beautiful spot offers sunsets, spirits and savory spreads.



Meeting Spaces That Impress

225,000 square feet of flexible meeting space, with unobstructed views for impactful general sessions and breakouts.

The Conference Center

Large or small, your group will find the perfect fit in our Conference Center. There's plenty of room for keynotes, exhibits, seminars, meals, meetings and even company celebrations — all staffed by our consummate service professionals in a grand ballroom setting.

- 22,500+ sq. ft.
- State-of-the-art technology and in-house AV support
- Breakout meeting rooms with flexible configurations
- Accommodates banquets for up to 800 guests
- Ground-level load-in access
- Private registration desk



The Event Center

A truly majestic space, The Event Center offers a 30,000-square-foot exhibit floor that can be configured to match your most specific needs. It also includes the 19,000-square-foot Atrium that provides an ideal setting for registration and other pre-function activities.

- Including the Atrium, 49,000+ sq. ft.
- In-house public address system for the event floor
- In-floor power supply
- Hosts up to 1,200 guests for a plated meal
- Accommodates up to 180 10x10' booths

The Showroom

Ideal for keynote addresses, The Showroom offers state-of-the-art lighting and sound, a luxurious bar and exceptionally comfortable theater seating.

- Stadium-style seating
- Accommodates up to 650 guests





Shenendoah Clubhouse

The Clubhouse is a favorite setting for executive board retreats, incentive meetings and corporate celebrations. This one-of-a-kind meeting space is steps away from the main resort.

- 5,900 sq. ft. that can be used as a single session or three breakouts
- Expansive room with fireplace and balcony
- Convenient self-parking
- Outdoor patio
- Adjacent to The Lodge
- Picturesque fairway views



The Lodge Boardroom

The Lodge Boardroom eclipses traditional meeting spaces by providing a serene space with private access to the scenic Great Lawn. The Boardroom is fully loaded with high-tech amenities and expert staff ready to assist.

- Seats up to 14
- Executive leather chairs
- Extensive charging ports
- Built-in telecommuting technology
- Large LCD video monitor
- Automated black-out shades for enhanced presentation clarity



Cypress Ballroom

A natural light-filled space that works exceptionally well for large meetings, elegant corporate celebrations and effective training events, The Cypress Ballroom is adjacent to The Event Center. Used as a single session or divided into as many as five breakout spaces, it is a versatile resource for any program.

- 5,700+ sq. ft.
- Flexible configuration
- Beautifully furnished

Tower Meeting Rooms

Perfect for small-group discussions, seminars and boardroom-style meetings, The Tower lends your gathering the right combination of intimacy, convenience and sophistication. These natural light-filled and fully equipped rooms serve as the ideal space for intimate receptions.

- Seven boardroom-style meeting rooms from 400 to 900+ sq. ft.
- Easy access to the parking garage, the hotels, Conference Center and dining





The Grand Expo

This majestic, state-of-the-art addition doubles our convention and conference space and features grand ballrooms, luxe breakout rooms, expansive, pillarless spaces, towering ceilings and natural light — and spectacular outdoor event spaces.

- Flexible meeting spaces, boardrooms and ballrooms, including the 30,000 sq. ft. Grand Ballroom
- Multiple courtyards totaling 24,219 sq. ft.
- Dedicated registration desks
- Connectivity to The Crescent hotel and indoor parking
- Arriving April 2027



The Conference Center

Specifications

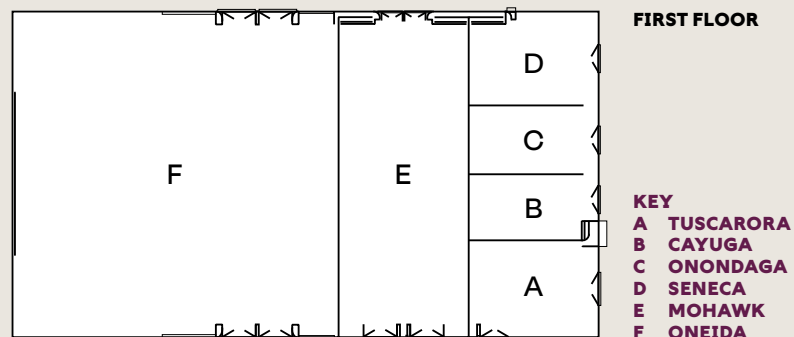

ROOM	DIMENSIONS	THEATER	CLASSROOM	BANQUET	SQ. FT.
Tuscarora	37'x55'	126	72	60	1,579
Cayuga	27'x51'	108	63	50	1,337
Onondaga	26'x51'	108	63	50	1,252
Seneca	33'x51'	126	72	60	1,609
Mohawk	116'x45'	540	270	230	5,212
Oneida	132'x101'	624	514	400	11,465
Combined	119'x196'	1,632	1,054	850	22,500

MINIMUM CEILING HEIGHT — 12 - 16 FEET

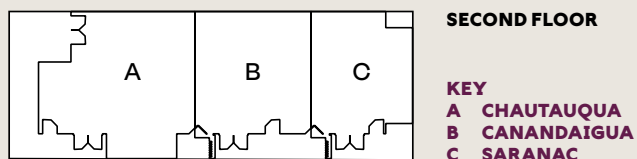

ROOM	DIMENSIONS	THEATER	CLASSROOM	BANQUET	SQ. FT.
Chautauqua	31'x32'	49	27	40	836
Canandaigua	25'x24'	40	27	30	618
Saranac	25'x21'	45	27	20	499
Combined	36'x80'	144	81	90	1,953

MINIMUM CEILING HEIGHT — 10 FEET

Cypress Ballroom

Specifications

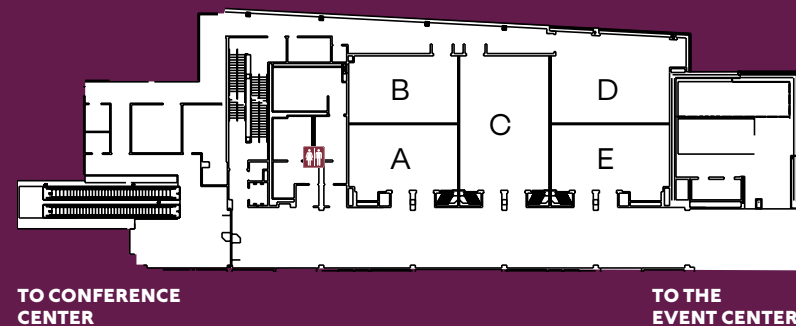

ROOM	DIMENSIONS	THEATER	CLASSROOM	BANQUET	SQ. FT.
Cypress A	23'x38'	50	36	40	933
Cypress B	23'x38'	60	36	30	893
Cypress C	47'x31'	126	72	60	1,509
Cypress D	23'x38'	72	57	40	1,346
Cypress E	23'x38'	50	42	40	1,024
Cypress A+B	47'x38'	126	84	60	1,826
Cypress D+E	56'x41'	180	108	90	2,370
Cypress Total	112'x56'	450	306	230	5,705

CEILING HEIGHT — 12 - 55 FEET

The Event Center

Specifications

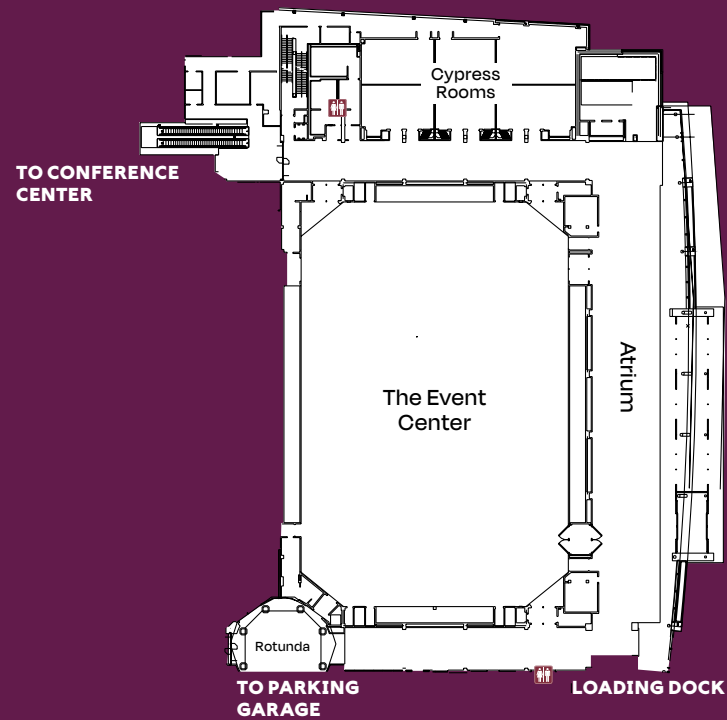

ROOM	SQ. FT.
The Event Center	29,868
Atrium	18,981
CEILING HEIGHT — 12 - 55 FEET	

Shenendoah Clubhouse

Specifications

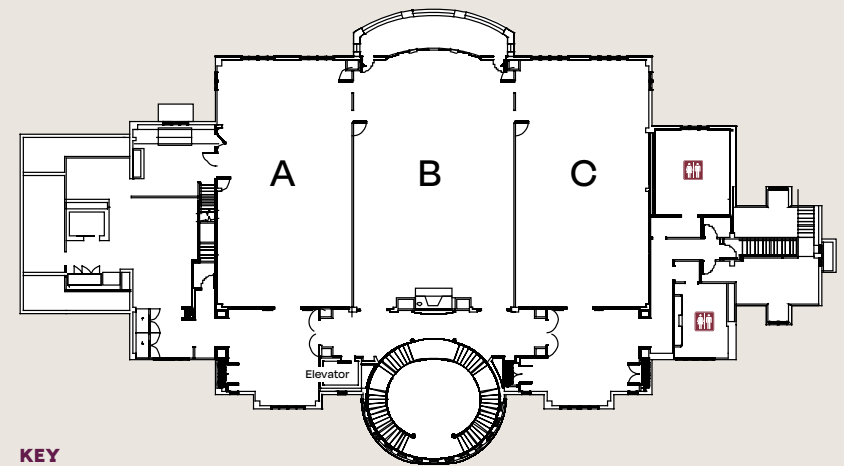

KEY
A APPALACHIAN
B ADIRONDACK
C CATSKILL

ROOM	DIMENSIONS	THEATER	CLASSROOM	BANQUET	SQ. FT.
Appalachian	32'x58'	154	84	70	1,851
Adirondack	38'x58'	176	84	90	2,221
Catskill	32'x58'	154	84	70	1,830
Combined	58'x102'	414	216	230	5,902
MINIMUM CEILING HEIGHT — 10 FEET					

The Lodge Boardroom

Specifications

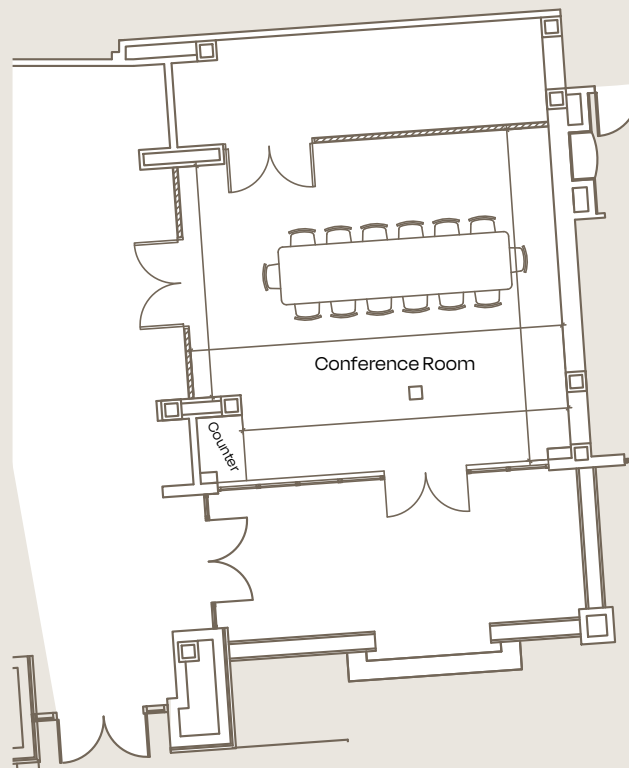

DIMENSIONS	CAPACITY	SQ. FT.
22'x25'	14	550
MINIMUM CEILING HEIGHT — 10 FEET		

The Tower Meeting Rooms

Specifications

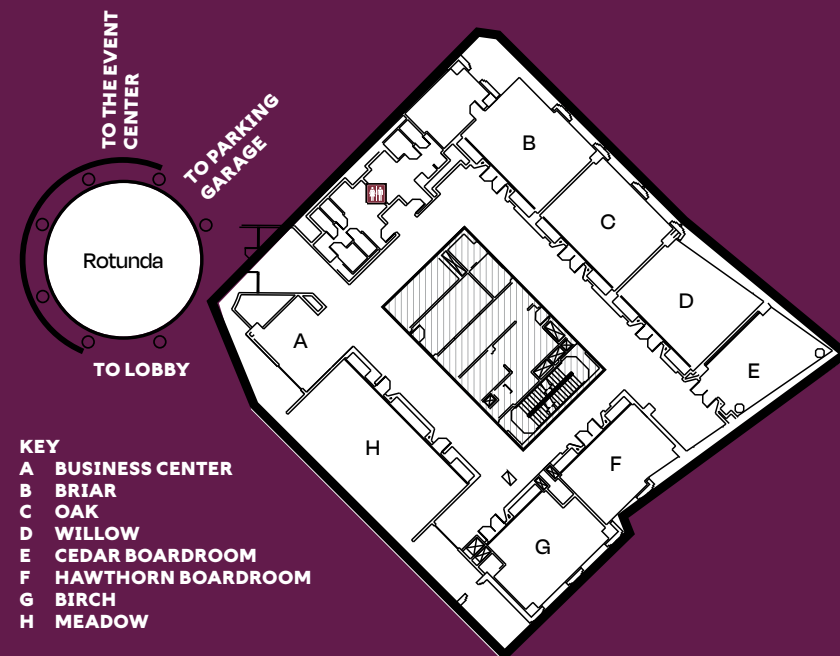

ROOM	DIMENSIONS	THEATER	CLASSROOM	BANQUET	SQ. FT.
Briar	23'x26'	50	22	30	581
Oak	23'x26'	46	24	30	571
Willow	26'x35'	46	24	30	587
Cedar	27'x19'	N/A	N/A	N/A	407
Hawthorn	19'x25'	N/A	N/A	N/A	459
Birch	22'x27'	34	18	20	513
Meadow	24'x43'	75	36	40	944
MINIMUM CEILING HEIGHT — 10 FEET					

The Grand Expo

Meeting Rooms

Specifications

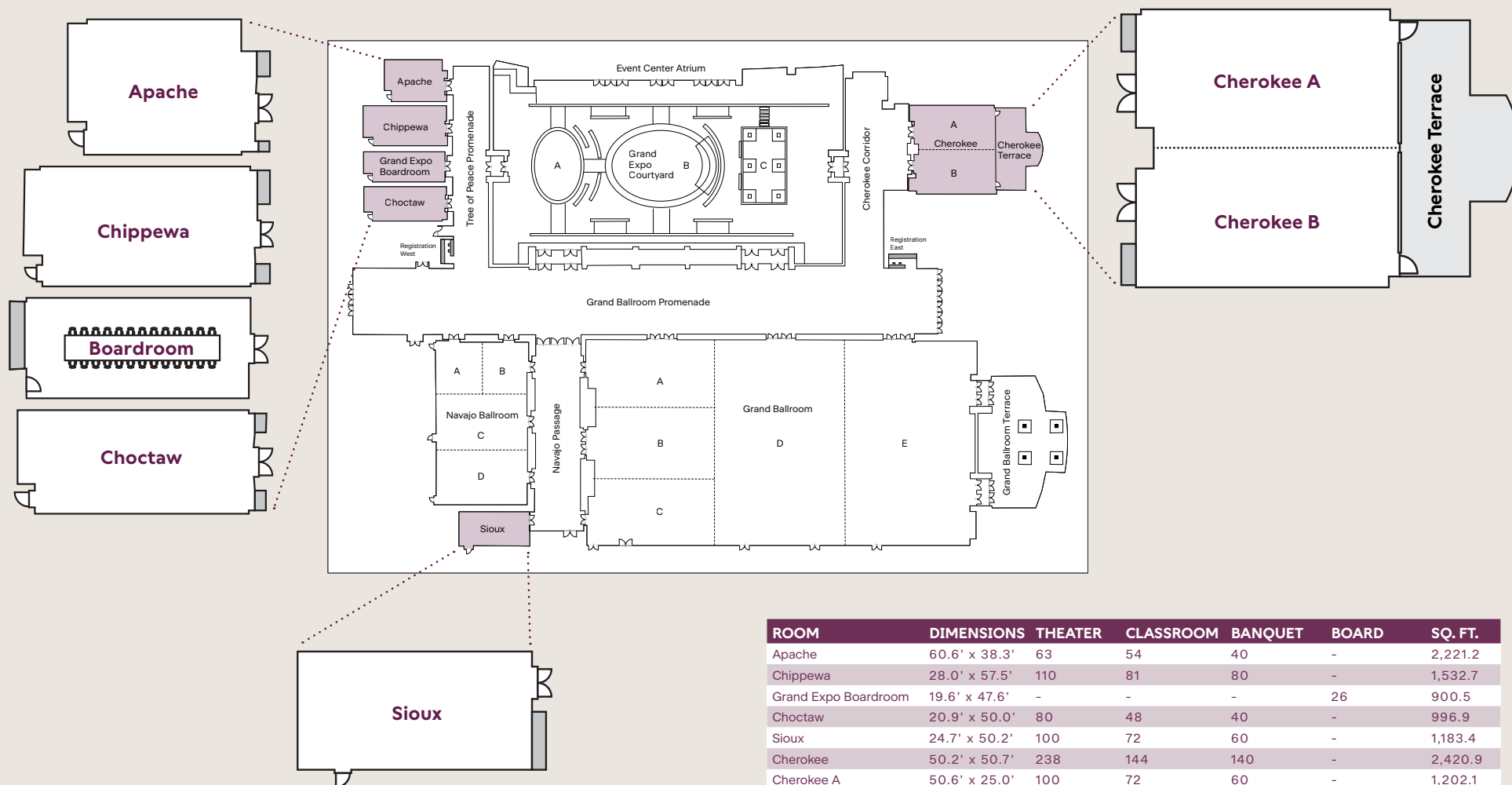

ROOM	DIMENSIONS	THEATER	CLASSROOM	BANQUET	BOARD	SQ. FT.
Apache	60.6' x 38.3'	63	54	40	-	2,221.2
Chippewa	28.0' x 57.5'	110	81	80	-	1,532.7
Grand Expo Boardroom	19.6' x 47.6'	-	-	-	26	900.5
Choctaw	20.9' x 50.0'	80	48	40	-	996.9
Sioux	24.7' x 50.2'	100	72	60	-	1,183.4
Cherokee	50.2' x 50.7'	238	144	140	-	2,420.9
Cherokee A	50.6' x 25.0'	100	72	60	-	1,202.1
Cherokee B	25.3' x 50.7'	100	72	60	-	1,218.2
Cherokee Terrace	51.5' x 23.9'	-	-	-	-	909.4

MINIMUM CEILING HEIGHT — 14 FEET

The Grand Expo

Navajo Ballroom

Specifications

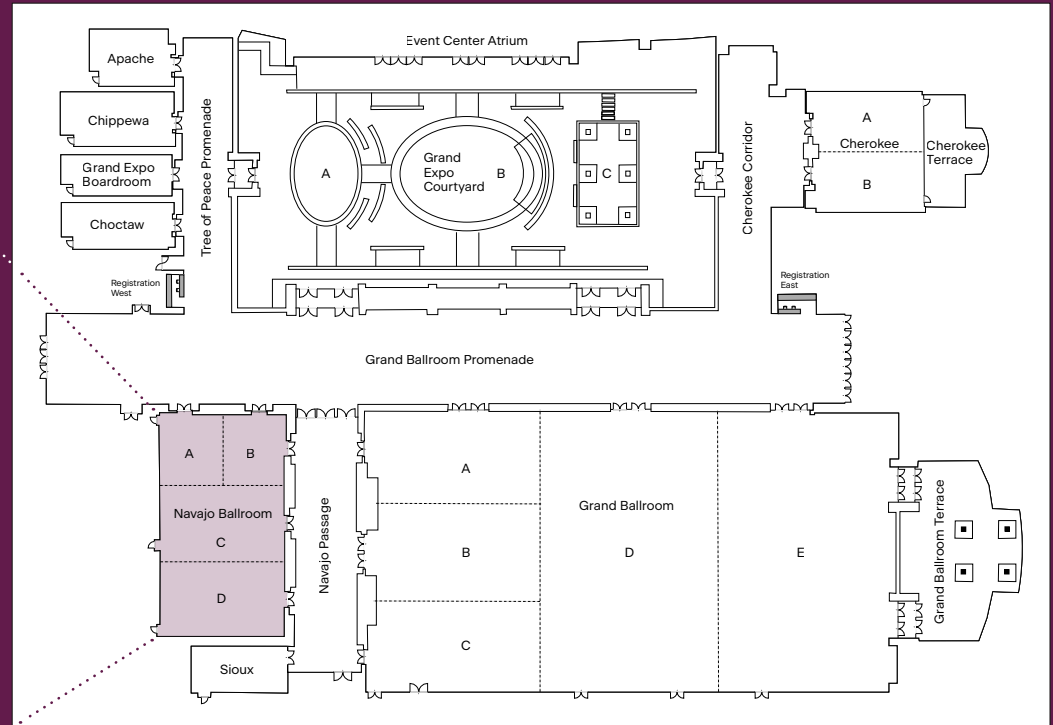
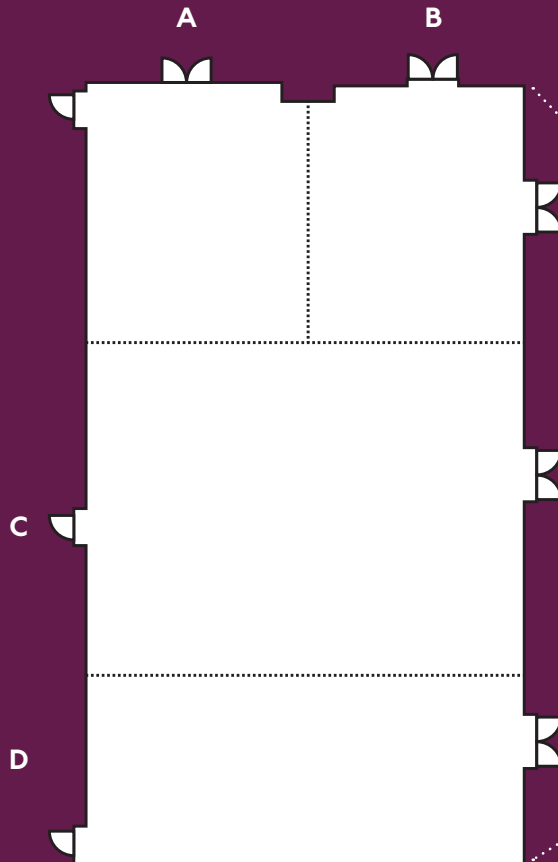

ROOM	DIMENSIONS	THEATER	CLASSROOM	BANQUET	SQ. FT.
Navajo Ballroom	99.5' x 58.7'	380	324	280	5,506.5
Navajo Ballroom A	32.5' x 29.9	70	45	40	917.3
Navajo Ballroom B	33.4' x 28.4'	70	45	40	895
Navajo Ballroom C	32.7' x 58.7'	180	95	80	1,830.3
Navajo Ballroom D	33.5' x 58.0'	180	95	80	1,863.8
MINIMUM CEILING HEIGHT — 12 FEET 1 INCH					

The Grand Expo Grand Ballroom Specifications

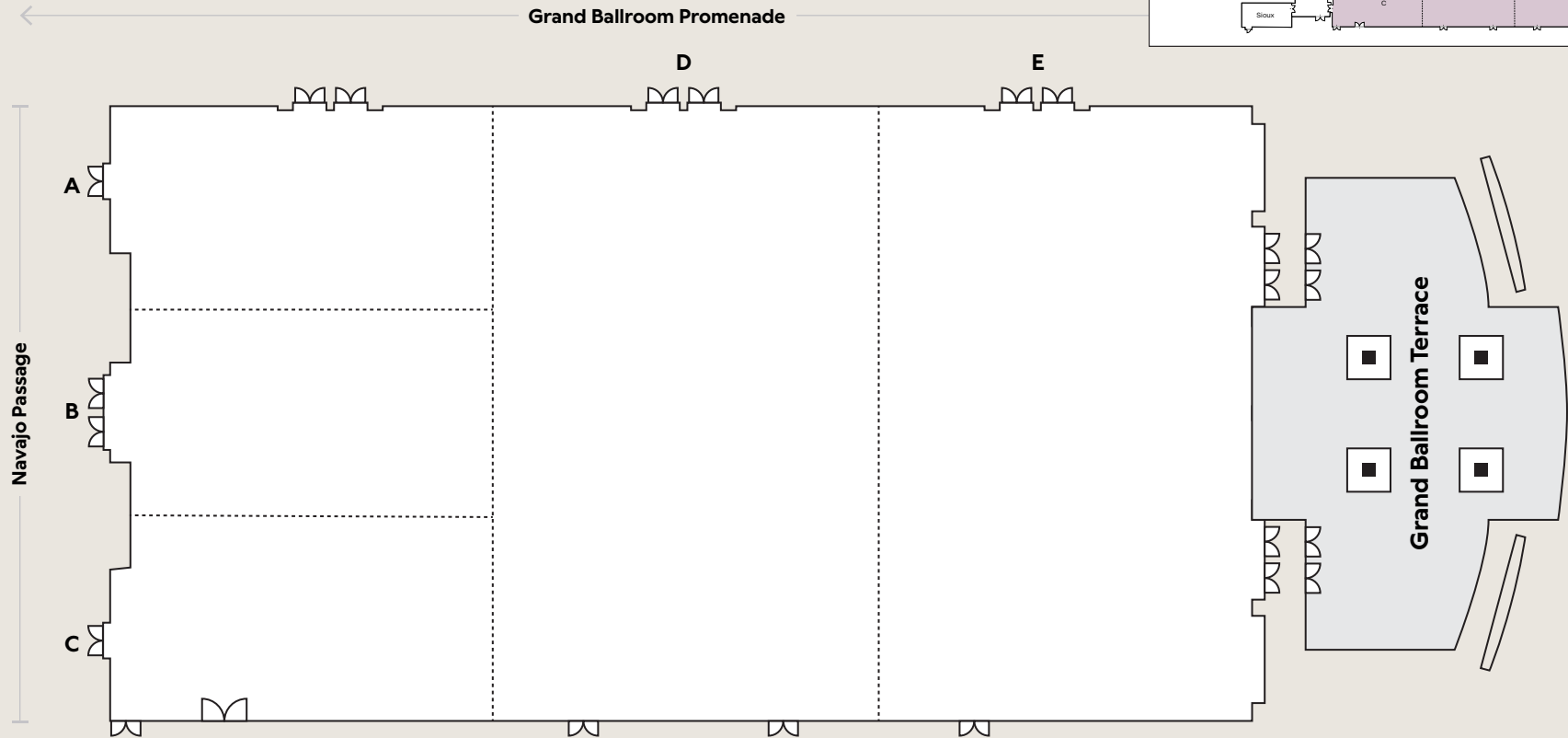

ROOM	DIMENSIONS	THEATER	CLASSROOM	BANQUET	SQ. FT.
Grand Ballroom	124.1' x 233.7'	1,880	1,126	1,280	28,397
Grand Ballroom A	41.2' x 78.1'	240	144	150	3,099.9
Grand Ballroom B	41.2' x 78.0'	240	144	150	3,096
Grand Ballroom C	41.5' x 78.1'	240	144	150	3,117.9
Grand Ballroom D	123.6' x 77.4'	800	480	450	9,527.7
Grand Ballroom E	123.6' x 78.1'	800	480	450	9,555.5
Grand Ballroom Terrace	81.5' x 55.0'	-	-	-	3,352.1
MINIMUM CEILING HEIGHT — 18 FEET 9 INCHES					

The Grand Expo Courtyard Specifications

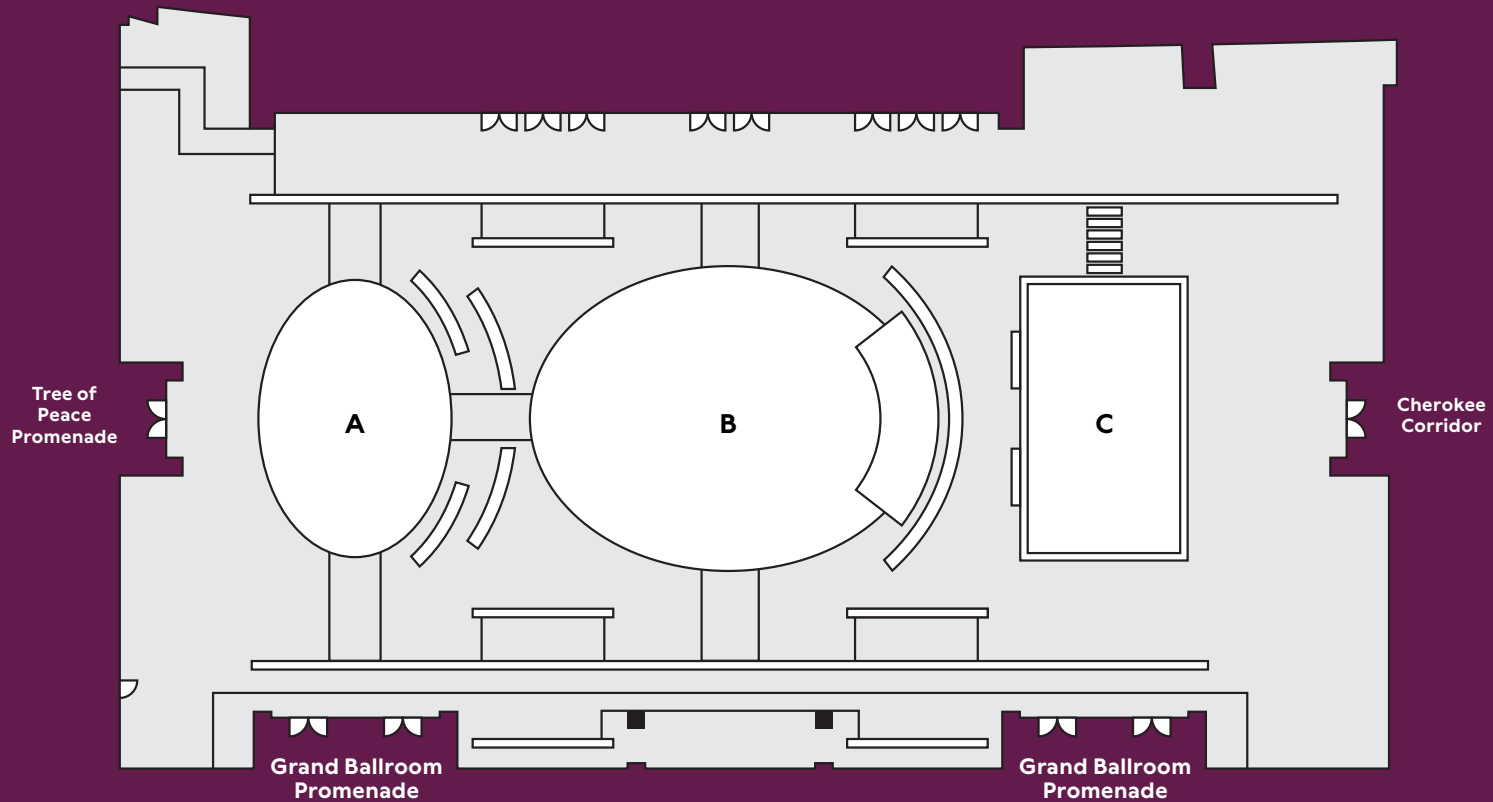
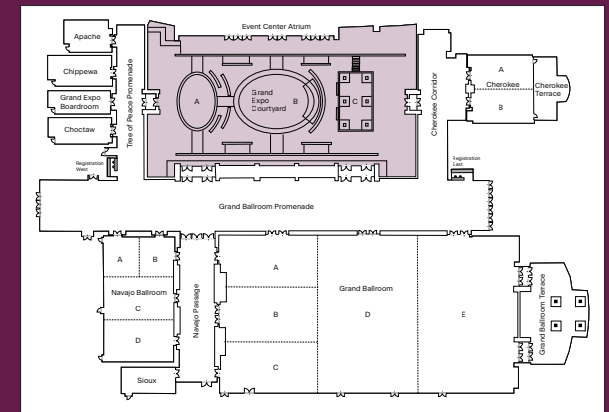

ROOM	DIMENSIONS	THEATER	CLASSROOM	BANQUET	SQ. FT.
Grand Expo Courtyard	130.0' x 217.7'	224	-	-	24,191.8



Award-Winning Golf

- Three world-class and two executive courses
- The Sportsplex at Turning Stone is open all year for practice, lessons and more
- Group lessons available

Atunyote

Designed by Tom Fazio, the parkland setting of Atunyote features gently rolling hills, small waterfalls and tree-lined fairways. Home to the PGA Tour's Turning Stone Resort Championship from 2007 to 2010, this layout will challenge your golf skills and excite your senses from start to finish.

Shenendoah

Designed by Rick Smith, Shenendoah encompasses the natural landscape to create a variety of parkland, links and low country-style holes. Playing over 7,000 yards from the back tees, Shenendoah can challenge any golfer but also offers great playability for any skill level. Beautiful scenery, wonderful routing and spectacular playing conditions are the trademarks of this course.

Kaluhyat

Kaluhyat features dramatic elevation changes and spectacular views. At 7,100 yards, distance off the tee is a bonus, but accuracy is a must on this classic shot-maker's layout. Come play this Robert Trent Jones Jr. designed course and you'll understand why Kaluhyat is consistently rated one of the most challenging layouts in New York State.

Relaxation and Recreation

Outdoor Recreation

Salmon Acres

36 acres on the banks of the world-renowned Salmon River. This could well be the finest salmon fishing you'll ever experience.

Sylvan Beach Supply Co.

Located on beautiful Oneida Lake, Sylvan Beach Supply Co. offers rentals of boats, kayaks, paddle boards, fishing gear, bikes and more.



Spas

Sk̓an̓: The Spa at Turning Stone

Sk̓an̓: the Oneida word for peace, is where soothing treatments and modern amenities combine with American Indian cultural themes to create the most luxuriously unique spa experience. Immerse yourself in the deep, restorative power of true spa therapy, exceptional services and stunning architecture.

Sk̓an̓: was honored with the Forbes Travel Guide Four-Star Award for the fifth consecutive year, as well as the #1 Spa in New York by Spas of America six times.

Áh̓si' Day Spa

Pass through the doors of Áh̓si' Day Spa, the Oneida word for “awaken,” and begin your personal journey toward relaxation and well-being. At Áh̓si', services focus on the awakening of mind, body and spirit.

Áh̓si' Aesthetics by Rome Health

Áh̓si' Aesthetics seamlessly blends luxurious wellness with high-quality healthcare thanks to treatments powered by the trusted expertise of Rome Health. Look and feel your best with med spa treatments like IV hydration, laser treatments, LED light therapy and more.



Nightlife at Exit 33

From live rock bands to luxurious lounges, we've got it all when it's time for your team to kick back. Available for private events or eclectic breakout meetings.

NY Rec & Social Club

The ultimate sports bar experience. Come for good times, great games, epic eats and signature cocktails.

Alchemist Bar

The perfect spot for a meet-up or casual sit-and-sip, serving specialty cocktails, crafted drinks and imported and domestic beers.

Tin Rooster Honky Tonk

One of Upstate NY's biggest and best country bars — where slow-smoked BBQ, music and line dancing come together in one larger-than-life barn.

Turquoise Tiger

Where elegance meets allure in a space designed for those who appreciate the finer things.

The Gig

A little retro, a little modern, all attitude — an electric, gritty hangout for bold vibes and big nights.

Exit 33 Courtyard

Located right outside all the nightlife happenings, featuring patio seating, a fire pit, yard games, twinkling lights and a full bar. Open seasonally.



Exit 33

Specifications

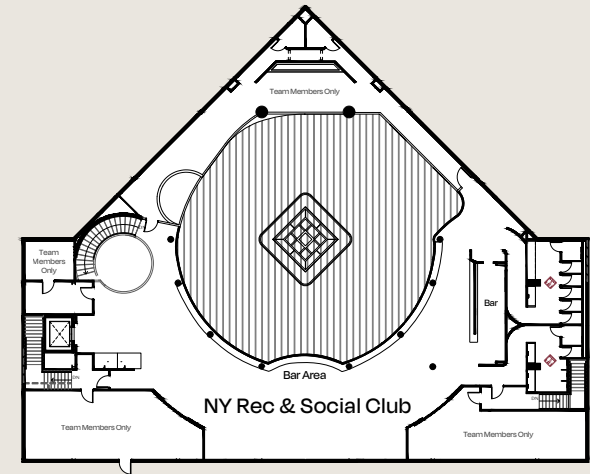
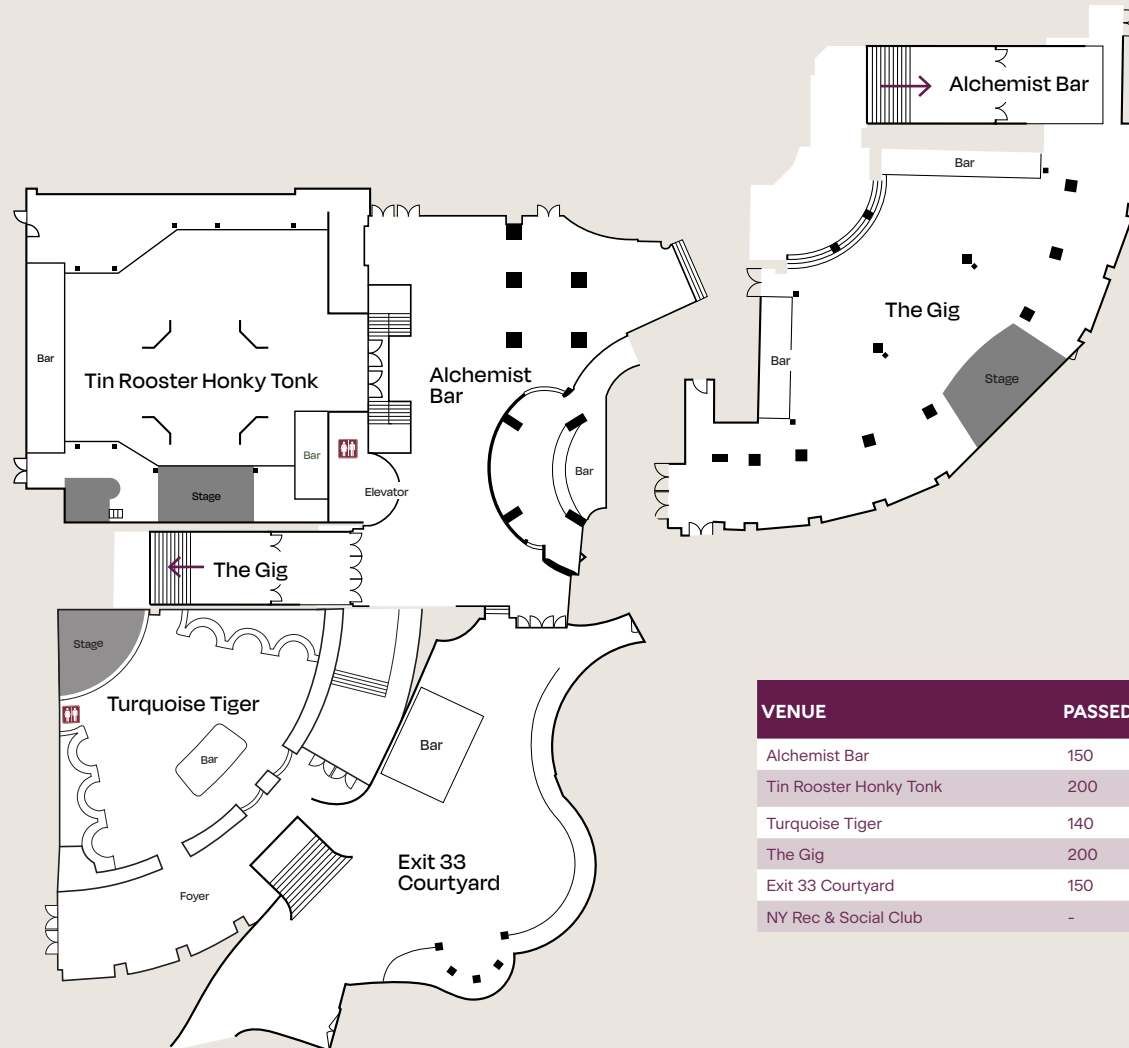

VENUE	PASSED RECEPTION	STATION RECEPTION	BANQUET
Alchemist Bar	150	100	90
Tin Rooster Honky Tonk	200	200	138
Turquoise Tiger	140	120	-
The Gig	200	200	100
Exit 33 Courtyard	150	100	50
NY Rec & Social Club	-	101	-

Property Maps

Overall Specifications

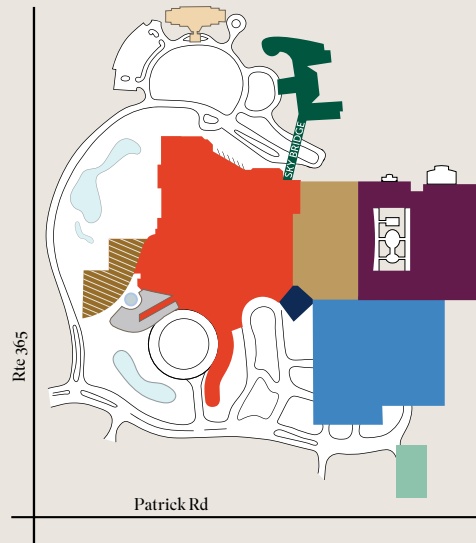

- | | |
|------------------|--------------------------|
| The Tower | Shenendoah Clubhouse |
| Casino | The Lodge and Skana: Spa |
| The Event Center | Sportsplex |
| The Brook | Parking Garage |
| Exit 33 | The Grand Expo |

SHENENDOAH CLUBHOUSE

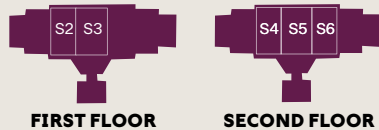

Shenendoah Clubhouse Clubhouse Area
 S2 The Grille At Shenendoah
 S3 Pro Shop

Shenendoah Clubhouse Conference Area
 S4 Appalachian
 S5 Adirondack
 S6 Catskill

Detail Specifications



Accommodations

- A1 Elevator To The Brook
- A2 The Brook And The Tower Front Desk
- A3 The Lodge Front Desk

Conference Center

- M1 Saranac
- M2 Canandaigua
- M3 Chautauqua
- M4 Tuscarora
- M5 Cayuga
- M6 Onondaga
- M7 Seneca
- M8 Mohawk
- M9 Oneida

Entertainment

- E1 The Event Center
- E2 The Showroom
- E3 NY Rec & Social Club
- E4 Tin Rooster Honky Tonk
- E5 The Gig
- E6 Turquoise Tiger

Gaming

- C1 TS Guest Services
- C2 Golden Dragon
- C3 Keno
- C4 Casino Gaming Floor
- C5 Casino Cashier
- C6 Poker Room
- C7 Casino Blu
- C8 High Stakes Bingo
- C9 Gaming Commission
- C10 TS Sports
- C11 The Parlor - Members Only

Recreation

- P1 The Brook Pool
- P2 The Tower Fitness Club & Pool

Restaurants, Bars And Lounges

- R1 Alchemist Bar
- R2 Peach Blossom
- R3 The Food Hall
- R4 Bar Pino
- R5 Pino Bianco
- R6 Sushi Sushi
- R7 Emerald Restaurant
- R8 Opals Confectionery
- R9 Motif Bar & Lounge
- R10 7 Kitchens
- R11 The Upstate Tavern
- R12 TS Steakhouse (21st Floor of The Tower)
- R13 Bar Blu
- R14 Wildflowers
- R15 The Lodge Bar
- R16 Tower Lounge
- R17 NY Rec & Social Club
- R18 Tin Rooster Honky Tonk

Retail

- S1 Oneida Heritage
- S2 Polly Cooper
- S3 Juniper
- S4 Revel Supply
- S5 Willow & Jaye
- S6 The Kiosk
- S7 Smokin' 2
- S8 The General Store
- S9 Mr. Shop

Spa

- L1 Áhsí' Day Spa
- L2 Skana: Spa

Convention Center

- The Tower Meeting Rooms
- T1 Business Center
- T2 Meadow
- T3 Hawthorn
- T4 Willow
- T5 Oak
- T6 Briar

The Event Center

- T7 The Event Center

Cypress Conference Area

- T8 Cypress A
- T9 Cypress B
- T10 Cypress C
- T11 Cypress D
- T12 Cypress E

The Grand Expo

- | | |
|-----------------------------|----------------------------|
| G1 White Pine Cafe | G11 Cherokee Meeting Room |
| G2 Apache Meeting Room | G12 Cherokee Terrace |
| G3 Chippewa Meeting Room | G13 Navajo Ballroom |
| G4 The Grand Expo Boardroom | G14 Sioux Meeting Room |
| G5 Choctaw Meeting Room | |
| G6 Registration East | Grand Ballroom |
| G7 Registration West | G15 Grand Ballroom |
| G8 Courtyard A | G16 Grand Ballroom Terrace |
| G9 Courtyard B | |
| G10 Courtyard C | |

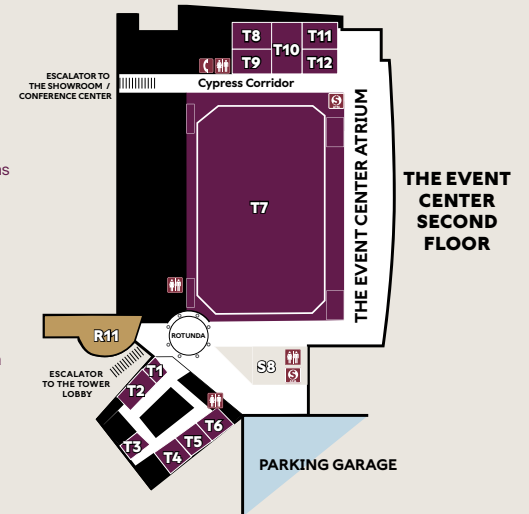

THE EVENT CENTER SECOND FLOOR